

PAVEMENT AND DRAINAGE IMPROVEMENTS

FOR

SADDLEBROOK PLAT XVII

MIDDLETON TOWNSHIP, WOOD COUNTY, OHIO

PROJECT DESCRIPTION

INSTALLATION OF 310 LINEAR FEET OF SADDLE HORN DRIVE AND 453 LINEAR FEET OF REDDINGTON COURT INCLUDING NEW PAVEMENT, CURBS, SIDEWALKS, STORM SEWERS AND SITE GRADING.

STANDARD DRAWINGS

<u>ODOT</u>	
RM-1.1 MONUMENT ASSEMBLY	7/18/14
MH-1.2 MANHOLE NO. 3	1/18/13
DM-4.4 CONSTRUCTION EROSION CONTROLS	7/20/12
CB-1.1 CATCH BASIN 2-2B	1/18/13
<u>WOOD COUNTY</u>	
TYPE "B" MONUMENT ASSEMBLY	
TYPE "B" TURNAROUND W/ BARRICADE	

SCALES

Site Grading Plan	1"=50'
Plan	1"=50'
Profile, Horizontal	1"=50'
Profile, Vertical	1"=5'
Cross-Sections, Horizontal	1"=20'
Cross-Sections, Vertical	1"=5'

APPROVED BY:

Raymond C. Huber **FEB 26, 2016**
 RAYMOND C. HUBER, PE, PS DATE

THE ABOVE SIGNATURE CONSTITUTES APPROVAL OF THOSE ITEMS OUTLINED IN THE WOOD COUNTY CONSTRUCTION STANDARDS OR AS AMENDED BY THE WOOD COUNTY ENGINEER. ALL TECHNICAL DETAILS REMAIN THE RESPONSIBILITY OF THE ENGINEER PREPARING THE PLANS.

SIGNATURE VALID FOR 18 MONTHS FROM DATE OF SIGNING.

DEVELOPED BY:

SADDLEBROOK DEVELOPMENT CO., LTD.
 3150 REPUBLIC BLVD. NORTH
 SUITE 3
 TOLEDO, OHIO 43615

Stephen R. Mitchell
 STEPHEN R. MITCHELL DATE

PREPARED BY:

ESA
Engineers, Surveyors & Associates, LLC
 5353 Secor Road, Toledo, Ohio, 43623
 Phone: (419) 475-9445. Fax: (419) 475-9473

Gregory L. Boudouris **2/9/2016**
 GREGORY L. BOUDOURIS, P.E., P.S. DATE

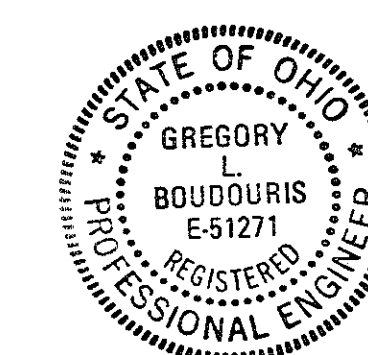

INDEX OF SHEETS

Title Sheet	1
General Notes	2
Typical Section, Details and General Summary	3
Site Grading Plan	4
Plan and Profiles	5
Cross Sections	6-10
Intersection Details & Signage	11
Villas at Saddlebrook Pond Storm Water Quality	12-13
Saddlebrook North Ponds Storm Water Quality	14

BENCH MARK DATA

Site Bench Mark

North Bonnet Bolt on Fire Hydrant North side of Stonebridge Lane,
 Station 9+39.91, 59.1' Lt., Elevation 644.87

Site Bench Mark

North Bonnet Bolt on Fire Hydrant South side of Saddle Horn Drive,
 Station 20+76.40, 19.0' Rt., Elevation 647.05

CONVENTIONAL SIGNS

Centerline	---
Existing Pavement	----
Existing Utilities
Fence Line	-x-x-
Power Pole	o
Telephone Pole	o
RM-1.1 Monument Assembly	o
Wood County Type A Monument Assembly	o
Storm Manhole	STMH
Catch Basin	CB
Yard Drain	YD
Sanitary Manhole	SAMH
Existing Storm Sewer	----
Proposed Storm Sewer	----

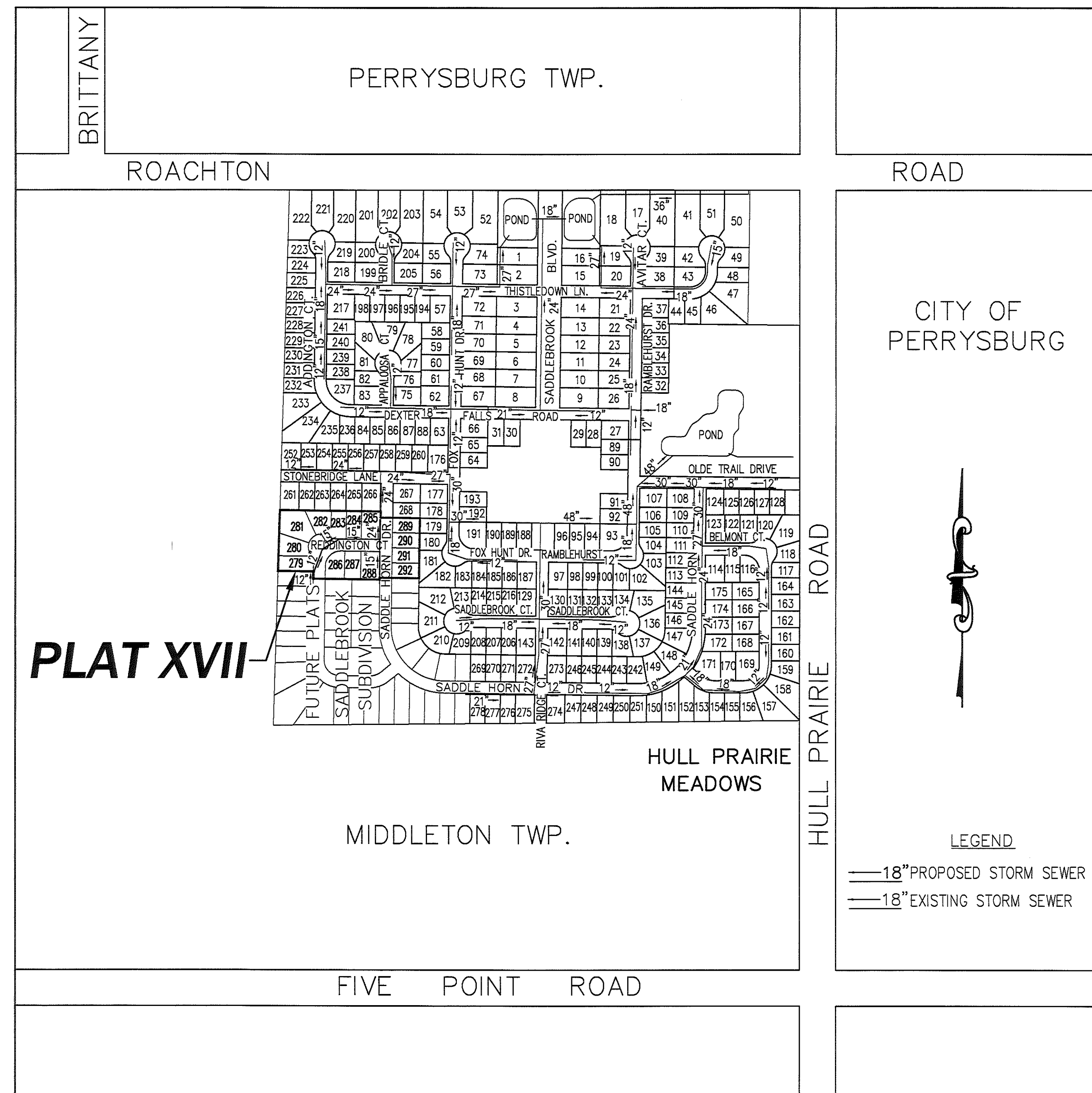

LOCATION MAP

1"=400'

UNDERGROUND UTILITIES

TWO WORKING DAYS
BEFORE YOU DIG
 Call 800-362-2764 (Toll Free)
 OHIO UTILITIES PROTECTION SERVICE
 NON-MEMBERS
 MUST BE CALLED DIRECTLY



Know what's below.
 Call before you dig.