

PLAT OF
 VILLAGE OF WAYNE
 DITCH NO. 2367
 MONTGOMERY TWP.
 MAX L. ROTHSCHILD WOOD CO. ENGINEER
 DRAINAGE AREA 24
 DITCH 24-L
 DITCH BOOK NO.

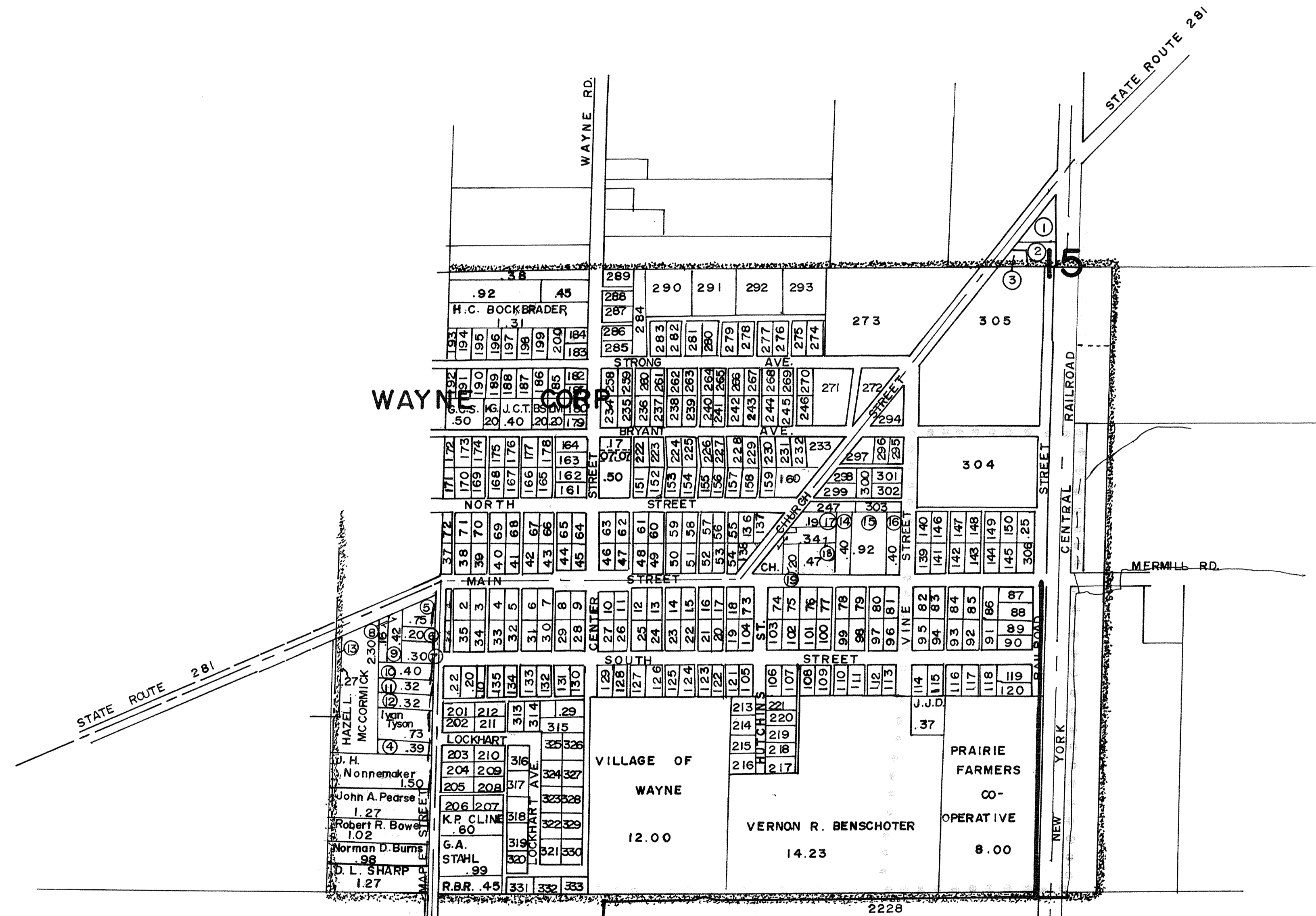

- | | | |
|------------------------|------|---------------------------|
| 1. CHALMER J. STAHL | 1.32 | 13 NORMAN L. LEWIS |
| 2. SAME | .28 | 14 M.E. PARSONAGE |
| 3. CLAYTON E. SCOTT | .22 | 15 G. MORRIS NONNEMAKER |
| 4. WAYNE ADAMS | | 16 TOLEDO TRUST CO. |
| 5. RICHARD NOBLE | | 17 J. N. FARABEE |
| 6. MARY FOSTER | | 18 WAYNE METHODIST CHURCH |
| 7. CHARLES A. STEAGELL | | 19 FRED A. BUCKINGHAM |
| 8. GEORGE W. HAZEL | | |
| 9. SAME | | |
| 10 MAUD I. HOILES | | |
| 11 FLORENCE I. CONNELL | | |
| 12 LEO J. FARABEE | | |